

LAND - CUSTOMER SYNOPSIS

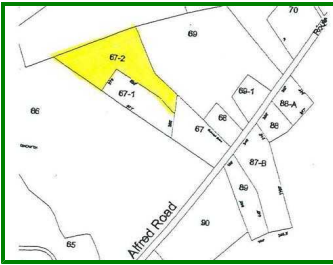

MLS#: 1004972 **Status:** Current
0 Colonial Drive, Lyman, ME 04002

List Price: \$ 59,900 **Kickout:** No
Original Price: \$ 69,000
List Date: 03/10/11
Assoc. Fee /Mo:

Neigh'd/Assoc:
Directions: Route 111 to Colonial Drive.

General/Land Information

Lot Size (Acr)+/-: 13.510 **Road Frontage+/-:**
Surveyed: Yes **Seasonal:** No **Zoning:** GP & COM
WtrFrt: No **Water Body:** **Water Body Type:**
Amt Wtr Frt+/-: **WtrFrt Owned+/-:** **WtrFrt Shared+/-:**

Remarks

Large house lot in private area near all amenities. Commercial uses possible.

Property Features - NOTE: Check Detail Reports for complete list of Features.

Site: Level, Pasture/Field, Wooded, Right of Way
Driveway: No Driveway
Parking:
Location: Rural, Near Shopping
Restrictions:
Rec. Water:
View:
Roads: Gravel/Dirt Road, Right Of Way, Private
Transportation:
Electric: On Site
Gas: No Gas
Waste Water Disp.: Septic Needed On Site, None
Water: None, Well Needed On Site

Tax/Deed/Community Information

Book/Page/Deed: 13259/108/All **Map/Block/Lot:** 7//67-2 **Full Tax Amount/Yr:** \$ 572 / (2011)
School District:

Off Market Information

Information Provided by: Danielle Lape DL 003995



Office: King Real Estate 1076
Agent Phone: 207-934-7622 Ext:14
Email: danielle@kingrealestate.com
Virtual Tour:

Office: 207-934-7622
Agent Cell: 207-730-2476

LAini: DL **List Office:** King Real Estate

Printed: 10/10/11



The information on MLS listings has been assembled from various sources of varying degrees of reliability. Any information that is critical to your buying decision should be independently verified. All dimensions are approximate and not guaranteed. Copyright MREIS, Inc. 2011

